

Specifications for pre-buried photovoltaic panels foundation



Overview

Key considerations for solar installations include foundation depth (typically 1/6 of pole height plus 2 feet), concrete strength, reinforcement design, and soil bearing capacity. Proper foundation engineering is crucial for long-term stability of solar lighting systems. The selected solar panel is known as Top-of-Pole Mount (TPM), where it is designed to install quickly and provide a secure mounting structure for PV modules on a single. Proper ground preparation and a strong foundation are essential for the efficiency and longevity of ground-mounted solar arrays. The project drawings are unique to each job site and are based on client specified t may supersede this installation manual.

Specifications for pre-buried photovoltaic panels foundation



Ground Mount Structure Installation Manual

The Solar Foundations Ground Mount Structure (Rack Mounting System) conforms to UL 2703 Standard for Safety First Edition: Mounting Systems, Mounting Devices, and Ground Lugs for Use with Flat-Plate ...

Solar Panel Foundation Design Guide , Installation & Engineering

Key considerations for solar installations include foundation depth (typically 1/6 of pole height plus 2 feet), concrete strength, reinforcement design, and soil bearing capacity. Proper ...

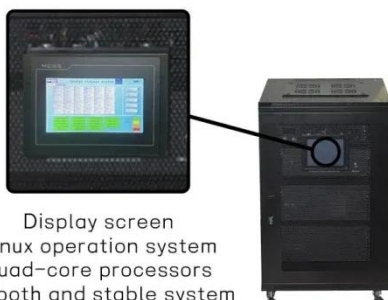

Display screen
Linux operation system
quad-core processors
smooth and stable system

Foundations of Solar Farms: Choosing the Right Piles and Installation

Knowing the site's geological characteristics allows engineers to choose the most suitable pile type and driving method, ensuring a stable foundation for the solar farm.

Ground Preparation and Foundation

for Solar Panel Arrays

In this article, we will delve into the crucial aspects of ground preparation and foundation for solar panel arrays, ensuring the longevity and efficiency of your solar power system.

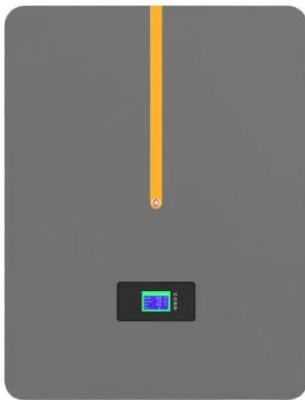

Pre-buried pipes for photovoltaic panel foundation

The unique pre-insulated pipes are also easy and fast to install in and on any building, with only a few components needed to deal with the entire range of pipe sizes and fitting specifications.

Ground Mounted PV Solar Panel Reinforced Concrete Foundation

All the information provided by the solar panel provider are shown in the following figure and design data section and will serve as input for detailed foundation analysis and design.



Specifications of photovoltaic panel cement piers

Selecting the right foundation for a ground-mounted solar PV installation is critical for its success as the use of an incorrect foundation can result in

premature refusal,



Ground Mounted PV Solar Foundation Design , PDF , Solar Panel

This document discusses the design of a reinforced concrete foundation for a ground-mounted solar panel system using engineering software. A spread footing foundation with a 36-inch diameter ...



Photovoltaic System Foundations: Key Factors for Optimal Selection

These factors collectively guide the selection of the most appropriate foundation type for photovoltaic installations, ensuring efficiency in both implementation and long-term operation while aligning ...

Photovoltaic panel foundation column

This document discusses the design of a

reinforced concrete foundation for a ground-mounted solar panel system using engineering software. A spread footing foundation with a 36-inch diameter concrete pier is ...

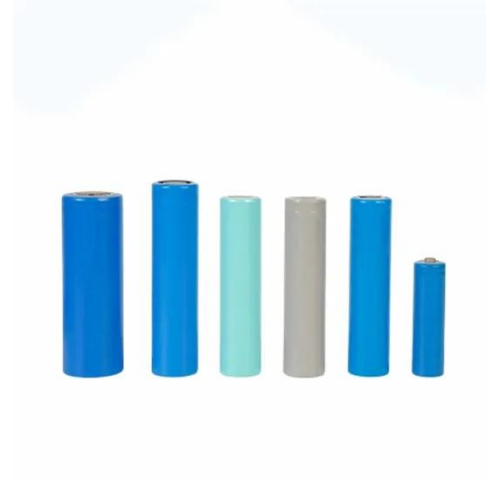

Contact Us

For catalog requests, pricing, or partnerships, please visit:
<https://www.scelto.co.za>

